

# FLT-2A

## LED Flexible Module

- IP 65 waterproof
- High beam effect efficiency
- Up to 8 m maximum length
- Low temperature



### FLT-2A - 1018 - N - K

- 1 Fixture name : FLT-2A= LED Flexible Module FLare Line Clear Outdoor
- 2 Length : 520, 1018, 1516, 2014 (other size possible)
- 3 LED color : L22 = Light bulb (2200K)  
L25 = Light bulb (2500K)  
L27 = Light bulb (2700K)  
L30 = Light bulb (3000K)  
WW = Warm white (3500K)  
W = White (4000K)  
N = Neutral white (5000K)  
D = Daylight (6500K)
- 4 Connector: None = standard/K = one end connector
- Environment of use : outdoor accent / architectural lighting
- Maximum length in series : 8m (7970mm)
- Driver : DC 24V

### Color temperature CCT

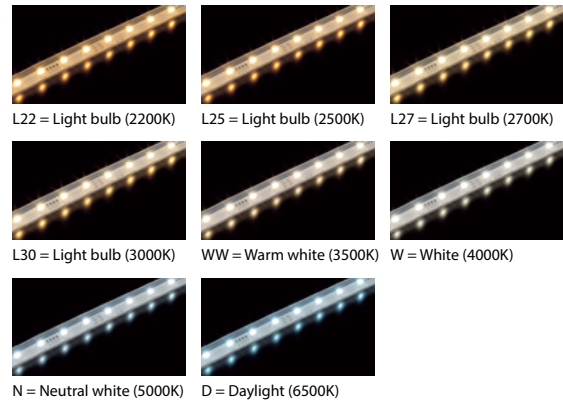

### Photometric data

Measured fixture: FLT-2A-1018-N

### Light Intensity distribution

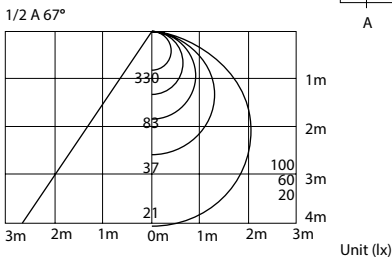

### Candlepower Distribution

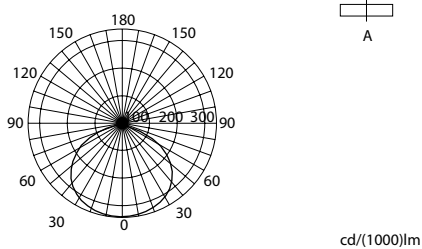

### Dimensions

Unit (mm)

External dimension (standard)

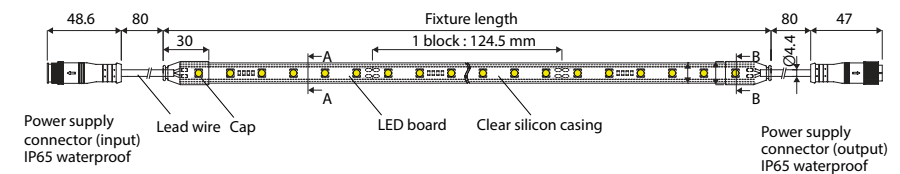

External dimension (K: one end connector)

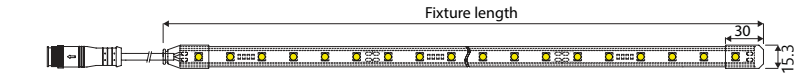

Cross sectional view A-A

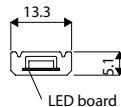

Cross sectional view B-B

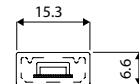

**DC 24V standard specifications**

Reference	Length (mm)	Weight (kg)	Number of LED	CRI (Ra)	Watts (W)	Amps (A)	Maximum length (m)	Luminous flux (lm)
FLT-2A-520	520	0.06	24	> 80 Ra	4.4	0.19	8	490
FLT-2A-1018	1018	0.10	48		8.9	0.37		980
FLT-2A-1516	1516	0.13	72		13.1	0.55		1470
FLT-2A-2014	2014	0.17	96		17.3	0.72		1960

**Order made sizes**

Reference	Length (mm)	Weight (kg)	No. of LED	Watts (W)	Amps (A)	Luminous flux (lm)
FLT-2A-147	147	0.03	6	1.1	0.046	123
FLT-2A-271	271	0.04	12	2.2	0.093	245
FLT-2A-396	396	0.05	18	3.3	0.139	368
FLT-2A-520	520	0.06	24	4.4	0.185	490
FLT-2A-645	645	0.06	30	5.6	0.231	613
FLT-2A-769	769	0.08	36	6.7	0.278	735
FLT-2A-894	894	0.09	42	7.8	0.324	858
FLT-2A-1018	1018	0.10	48	8.9	0.370	980
FLT-2A-1143	1143	0.10	54	9.9	0.414	1103
FLT-2A-1267	1267	0.11	60	11.0	0.458	1225
FLT-2A-1392	1392	0.12	66	12.0	0.501	1348
FLT-2A-1516	1516	0.13	72	13.1	0.545	1470
FLT-2A-1641	1641	0.14	78	14.1	0.589	1589
FLT-2A-1765	1765	0.15	84	15.2	0.633	1709
FLT-2A-1890	1890	0.16	90	16.2	0.676	1828
FLT-2A-2014	2014	0.17	96	17.3	0.720	1908
FLT-2A-2139	2139	0.18	102	18.3	0.763	2023
FLT-2A-2263	2263	0.18	108	19.4	0.807	2137
FLT-2A-2388	2388	0.19	114	20.4	0.850	2252
FLT-2A-2512	2512	0.20	120	21.4	0.894	2367
FLT-2A-2637	2637	0.21	126	23.5	0.937	2481
FLT-2A-2761	2761	0.22	132	24.6	0.980	2596
FLT-2A-2886	2886	0.23	138	25.6	1.024	2710
FLT-2A-3010	3010	0.24	144	25.6	1.067	2825
FLT-2A-3135	3135	0.25	150	26.6	1.108	2935
FLT-2A-3259	3259	0.25	156	27.6	1.150	3045
FLT-2A-3384	3384	0.26	162	28.6	1.191	3155
FLT-2A-3508	3508	0.27	168	29.6	1.232	3266
FLT-2A-3633	3633	0.28	174	30.6	1.315	3376
FLT-2A-3757	3757	0.29	180	31.5	1.356	3486
FLT-2A-3882	3882	0.30	186	32.5	1.397	3596
FLT-2A-4006	4006	0.31	192	33.5	1.397	3706

Reference	Length (mm)	Weight (kg)	No. of LED	Watts (W)	Amps (A)	Luminous flux (lm)
FLT-2A-4131	4131	0.32	198	34.5	1.437	3814
FLT-2A-4255	4255	0.32	204	35.4	1.476	3921
FLT-2A-4380	4380	0.33	210	36.4	1.516	4029
FLT-2A-4504	4504	0.34	216	37.3	1.555	4136
FLT-2A-4629	4629	0.35	222	38.3	1.595	4244
FLT-2A-4753	4753	0.36	228	39.2	1.634	4351
FLT-2A-4878	4878	0.37	234	40.2	1.674	4459
FLT-2A-5002	5002	0.38	240	41.1	1.714	4566
FLT-2A-5127	5127	0.39	246	42.0	1.752	4673
FLT-2A-5251	5251	0.40	252	43.0	1.790	4780
FLT-2A-5376	5376	0.40	258	43.9	1.828	4887
FLT-2A-5500	5500	0.41	264	44.8	1.866	4994
FLT-2A-5625	5625	0.42	270	45.7	1.904	5100
FLT-2A-5749	5749	0.43	276	46.6	1.942	5207
FLT-2A-5874	5874	0.44	282	47.5	1.980	5314
FLT-2A-5998	5998	0.45	288	48.4	2.018	5421
FLT-2A-6123	6123	0.46	294	49.3	2.054	5525
FLT-2A-6247	6247	0.47	300	50.2	2.090	5628
FLT-2A-6372	6372	0.47	306	51.0	2.126	5732
FLT-2A-6496	6496	0.48	312	51.9	2.163	5836
FLT-2A-6621	6621	0.49	318	52.8	2.199	5939
FLT-2A-6745	6745	0.50	324	53.6	2.235	6043
FLT-2A-6870	6870	0.51	330	54.5	2.271	6146
FLT-2A-6994	6994	0.52	336	55.4	2.308	6250
FLT-2A-7119	7119	0.53	342	56.3	2.344	6349
FLT-2A-7243	7243	0.54	348	57.1	2.380	6448
FLT-2A-7368	7368	0.54	354	58.0	2.416	6547
FLT-2A-7492	7492	0.55	360	58.9	2.453	6646
FLT-2A-7617	7617	0.56	366	59.7	2.489	6745
FLT-2A-7741	7741	0.57	372	60.6	2.525	6844
FLT-2A-7866	7866	0.58	378	61.5	2.561	6943
FLT-2A-7990	7990	0.59	384	62.3	2.598	7042

\* Maximum length 8m. If you want to connect more than 8m, please connect the system in parallel.  
 \* Standard sizes. For other dimensions, please contact us.

## Option parts

### Mounting bracket FLT-CR

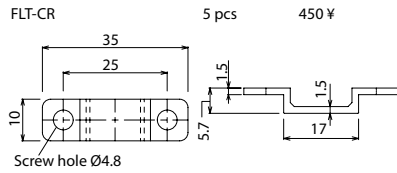

### Mounting clip FLT-RLC

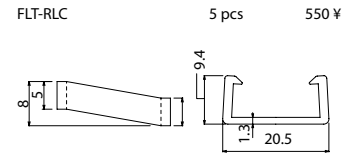

### Mounting rail FLT-RL

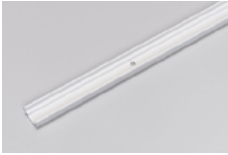

FLT-RL-500	470mm	1 pcs	1500 ¥
FLT-RL-1000	970mm	1 pcs	1700 ¥
FLT-RL-1500	1470mm	1 pcs	2000 ¥
FLT-RL-2900	1970mm	1 pcs	2500 ¥

In case of FLT-RL-500/1000 you shall use 5 mounting clip.  
In case of FLT-RL-1500/2000 you shall use 10 mounting clip.

### Jumper cable FMP-DG



FMP-DG	3000 mm	1 pcs	3500 ¥
--------	---------	-------	--------

### Power supply out cable FMP-1



FMP-1	500mm	1 pcs	2500 ¥
-------	-------	-------	--------

### Power supply in lead cable FMP-2



FMP-2	500mm	1 pcs	2500 ¥
-------	-------	-------	--------

### Power supply unit (OSRAM OT)



OT30/100-200-24-T	30W	1 pcs	Open price
OT60/100-200-24-T	60W	1 pcs	Open price
OT90/100-200-24-T	90W	1 pcs	Open price
OT150/100-200-24-T	150W	1 pcs	Open price

Input AC90~240V, output DC24V.  
Comply with CE, UL, PSE standards. IP 66 water proof rating.

### DC 24V dimmer FMC-24S/R



FMC-24S/R	1 pcs	34500 ¥
-----------	-------	---------

Available in 3 colors:



### DC 24V simple dimmer FSD-24

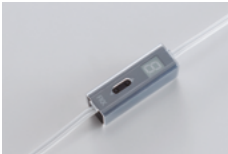

FSD-24	1 pcs	9900 ¥
--------	-------	--------

## Installation / Power supply connection

Mounting rail installation

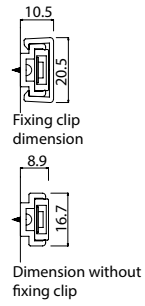
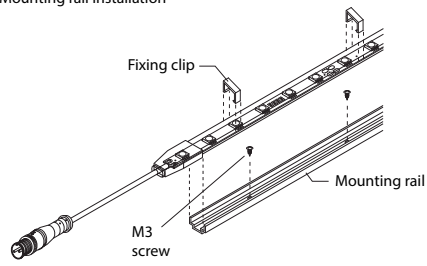

Mounting bracket installation

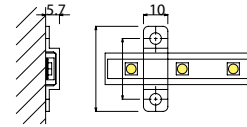
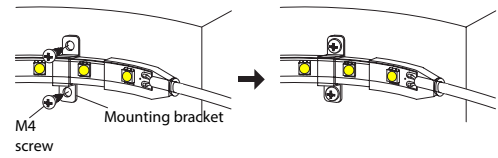

\* Please always use washers when fixing the brackets.

## Installation / Power supply connection

