

FLT-3A

LED Flexible Module

- IP 65 waterproof
- High luminosity
- Up to 6.5 m maximum length
- Low temperature



FLT-3A - 1016 - N - K

- 1 Fixture name : FLT-3A= LED Flexible Module FLare Line Clear Outdoor
- 2 Length : 518, 1016, 1514, 2012 (other size possible)
- 3 LED color :
 L25 = Light bulb (2500K)
 L27 = Light bulb (2700K)
 L30 = Light bulb (3000K)
 WW = Warm white (3500K)
 W = White (4000K)
 N = Neutral white (5000K)
 D = Daylight (6500K)
- 4 Connector: None = standard/K = one end connector
- Environment of use : outdoor accent / architectural lighting
- Maximum length in series : 6.5m (6489mm)
- Driver : DC 24V

Color temperature CCT

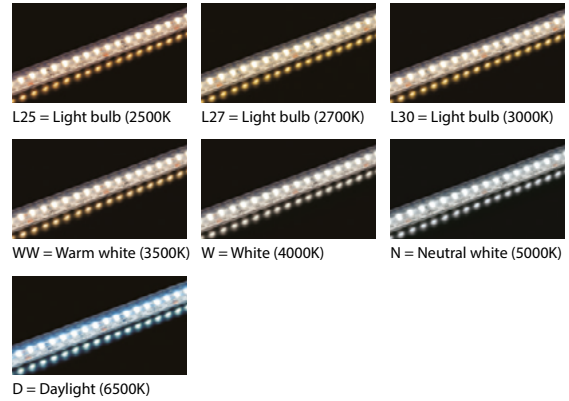

Photometric data

Measured fixture: FLT-3A-1016-N

Light Intensity distribution

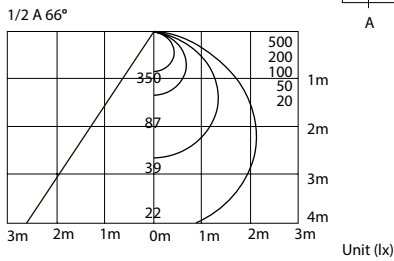

Candlepower Distribution

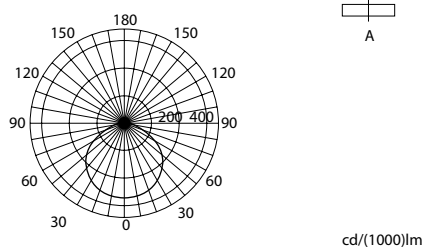

Dimensions

Unit (mm)

External dimension

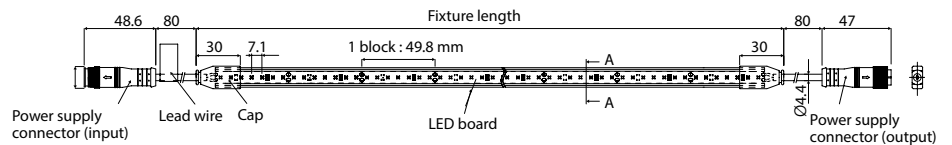

Cross sectional view A-A

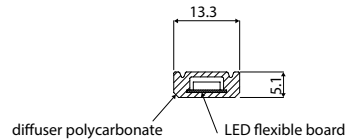

Order made sizes

Reference	Length (mm)	Weight (kg)	No. of LED	Watts (W)	Amps (A)	Luminous flux (lm)
FLT-3A-70	70	0.024	7	0.5	0.02	53
FLT-3A-120	120	0.049	14	1.0	0.04	106
FLT-3A-169	169	0.073	21	1.4	0.06	159
FLT-3A-219	219	0.098	28	1.9	0.08	212
FLT-3A-269	269	0.122	35	2.4	0.10	265
FLT-3A-319	319	0.146	42	2.9	0.12	318
FLT-3A-369	369	0.171	49	3.4	0.14	371
FLT-3A-418	418	0.195	56	3.8	0.16	424
FLT-3A-468	468	0.220	63	4.3	0.18	477
FLT-3A-518	518	0.244	70	4.8	0.20	530
FLT-3A-568	568	0.268	77	5.3	0.22	583
FLT-3A-618	618	0.293	84	5.8	0.24	636
FLT-3A-667	667	0.317	91	6.2	0.26	689
FLT-3A-717	717	0.342	98	6.7	0.28	742
FLT-3A-767	767	0.366	105	7.2	0.30	795
FLT-3A-817	817	0.390	112	7.7	0.32	848
FLT-3A-867	867	0.415	119	8.2	0.34	901
FLT-3A-916	916	0.439	126	8.6	0.36	954
FLT-3A-966	966	0.464	133	9.1	0.38	1007
FLT-3A-1016	1016	0.488	140	9.6	0.40	1060
FLT-3A-1066	1066	0.512	147	10.1	0.42	1113
FLT-3A-1116	1116	0.537	154	10.6	0.44	1166
FLT-3A-1165	1165	0.561	161	11.0	0.46	1219
FLT-3A-1215	1215	0.586	168	11.5	0.48	1272
FLT-3A-1265	1265	0.610	175	12.0	0.50	1325
FLT-3A-1315	1315	0.634	182	12.5	0.52	1378
FLT-3A-1365	1365	0.659	189	13.0	0.54	1431
FLT-3A-1414	1414	0.683	196	13.4	0.56	1484
FLT-3A-1464	1464	0.708	203	13.9	0.58	1537
FLT-3A-1514	1514	0.732	210	14.4	0.60	1590
FLT-3A-1564	1564	0.756	217	14.9	0.62	1643
FLT-3A-1614	1614	0.781	224	15.4	0.64	1696
FLT-3A-1663	1663	0.805	231	15.8	0.66	1749
FLT-3A-1713	1713	0.830	238	16.3	0.68	1802
FLT-3A-1763	1763	0.854	245	16.8	0.70	1855
FLT-3A-1813	1813	0.878	252	17.3	0.72	1908
FLT-3A-1863	1863	0.903	259	17.8	0.74	1961
FLT-3A-1912	1912	0.927	266	18.2	0.76	2014
FLT-3A-1962	1962	0.952	273	18.7	0.78	2067
FLT-3A-2012	2012	0.976	280	19.2	0.80	2120
FLT-3A-2062	2062	1.000	287	19.7	0.82	2173
FLT-3A-2112	2112	1.025	294	20.2	0.84	2226
FLT-3A-2161	2161	1.049	301	20.6	0.86	2279
FLT-3A-2211	2211	1.074	308	21.1	0.88	2332
FLT-3A-2261	2261	1.098	315	21.6	0.90	2385
FLT-3A-2311	2311	1.122	322	22.1	0.92	2438
FLT-3A-2361	2361	1.147	329	22.6	0.94	2491
FLT-3A-2410	2410	1.171	336	23.0	0.96	2544
FLT-3A-2460	2460	1.196	343	23.5	0.98	2597
FLT-3A-2510	2510	1.220	350	24.0	1.00	2650
FLT-3A-2560	2560	1.244	357	24.5	1.02	2703
FLT-3A-2610	2610	1.269	364	25.0	1.04	2756
FLT-3A-2659	2659	1.293	371	25.4	1.06	2809
FLT-3A-2709	2709	1.318	378	25.9	1.08	2862
FLT-3A-2759	2759	1.342	385	26.4	1.10	2915
FLT-3A-2809	2809	1.366	392	26.9	1.12	2968
FLT-3A-2859	2859	1.391	399	27.4	1.14	3021
FLT-3A-2908	2908	1.415	406	27.8	1.16	3074
FLT-3A-2958	2958	1.440	413	28.3	1.18	3127
FLT-3A-3008	3008	1.464	420	28.8	1.20	3180
FLT-3A-3058	3058	1.488	427	29.3	1.22	3233
FLT-3A-3108	3108	1.513	434	29.8	1.24	3286
FLT-3A-3157	3157	1.537	441	30.2	1.26	3339
FLT-3A-3207	3207	1.562	448	30.7	1.28	3392
FLT-3A-3257	3257	1.586	455	31.2	1.30	3445

Reference	Length (mm)	Weight (kg)	No. of LED	Watts (W)	Amps (A)	Luminous flux (lm)
FLT-3A-3307	3307	1.610	462	31.7	1.32	3498
FLT-3A-3357	3357	1.635	469	32.2	1.34	3551
FLT-3A-3406	3406	1.659	476	32.6	1.36	3604
FLT-3A-3456	3456	1.684	483	33.1	1.38	3657
FLT-3A-3506	3506	1.708	490	33.6	1.40	3710
FLT-3A-3556	3556	1.732	497	34.1	1.42	3612
FLT-3A-3606	3606	1.757	504	34.6	1.44	3663
FLT-3A-3655	3655	1.781	511	35.0	1.46	3714
FLT-3A-3705	3705	1.806	518	35.5	1.48	3765
FLT-3A-3755	3755	1.830	525	36.0	1.50	3816
FLT-3A-3805	3805	1.854	532	36.5	1.52	3867
FLT-3A-3855	3855	1.879	539	37.0	1.54	3918
FLT-3A-3904	3904	1.903	546	37.4	1.56	3969
FLT-3A-3954	3954	1.928	553	37.9	1.58	4020
FLT-3A-4004	4004	1.952	560	38.4	1.60	4070
FLT-3A-4054	4054	1.976	567	38.9	1.62	4121
FLT-3A-4104	4104	2.001	574	39.4	1.64	4172
FLT-3A-4153	4153	2.025	581	39.8	1.66	4223
FLT-3A-4203	4203	2.050	588	40.3	1.68	4274
FLT-3A-4253	4253	2.074	595	40.8	1.70	4325
FLT-3A-4303	4303	2.098	602	41.3	1.72	4376
FLT-3A-4353	4353	2.123	609	41.8	1.74	4427
FLT-3A-4402	4402	2.147	616	42.2	1.76	4477
FLT-3A-4452	4452	2.172	623	42.7	1.78	4528
FLT-3A-4502	4502	2.196	630	43.2	1.80	4579
FLT-3A-4552	4552	2.220	637	43.7	1.82	4630
FLT-3A-4602	4602	2.245	644	44.2	1.84	4681
FLT-3A-4651	4651	2.269	651	44.6	1.86	4732
FLT-3A-4701	4701	2.294	658	45.1	1.88	4783
FLT-3A-4751	4751	2.318	665	45.6	1.90	4834
FLT-3A-4801	4801	2.342	672	46.1	1.92	4884
FLT-3A-4851	4851	2.367	679	46.6	1.94	4935
FLT-3A-4900	4900	2.391	686	47.0	1.96	4986
FLT-3A-4950	4950	2.416	693	47.5	1.98	5037
FLT-3A-5000	5000	2.440	700	48.0	2.00	5088
FLT-3A-5050	5050	2.464	707	48.5	2.02	5032
FLT-3A-5100	5100	2.489	714	49.0	2.04	5082
FLT-3A-5149	5149	2.513	721	49.4	2.06	5131
FLT-3A-5199	5199	2.538	728	49.9	2.08	5181
FLT-3A-5249	5249	2.562	735	50.4	2.10	5231
FLT-3A-5299	5299	2.586	742	50.9	2.12	5281
FLT-3A-5349	5349	2.611	749	51.4	2.14	5331
FLT-3A-5398	5398	2.635	756	51.8	2.16	5381
FLT-3A-5448	5448	2.660	763	52.3	2.18	5430
FLT-3A-5498	5498	2.684	770	52.8	2.20	5480
FLT-3A-5548	5548	2.708	777	53.3	2.22	5530
FLT-3A-5598	5598	2.733	784	53.8	2.24	5580
FLT-3A-5647	5647	2.757	791	54.2	2.26	5630
FLT-3A-5697	5697	2.782	798	54.7	2.28	5679
FLT-3A-5747	5747	2.806	805	55.2	2.30	5729
FLT-3A-5797	5797	2.830	812	55.7	2.32	5779
FLT-3A-5847	5847	2.855	819	56.2	2.34	5829
FLT-3A-5896	5896	2.879	826	56.6	2.36	5879
FLT-3A-5946	5946	2.904	833	57.1	2.38	5929
FLT-3A-5996	5996	2.928	840	57.6	2.40	5978
FLT-3A-6046	6046	2.952	847	58.1	2.42	6028
FLT-3A-6096	6096	2.977	854	58.6	2.44	6078
FLT-3A-6145	6145	3.001	861	59.0	2.46	6128
FLT-3A-6195	6195	3.026	868	59.5	2.48	6178
FLT-3A-6245	6245	3.050	875	60.0	2.50	6228
FLT-3A-6295	6295	3.074	882	60.5	2.52	6277
FLT-3A-6345	6345	3.099	889	61.0	2.54	6327
FLT-3A-6394	6394	3.123	896	61.4	2.56	6377
FLT-3A-6444	6444	3.148	903	61.9	2.58	6427
FLT-3A-6494	6494	3.172	910	62.4	2.60	6477

* Maximum standard length 6.5m. For longer specification, please contact us.

Option parts

Mounting bracket FLT-CR

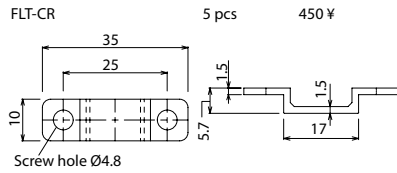

Mounting clip FLT-RLC

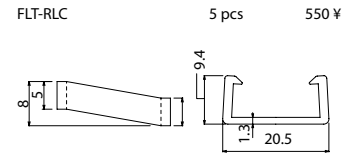

Mounting rail FLT-RL

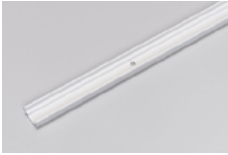

FLT-RL-500	470mm	1 pcs	1500 ¥
FLT-RL-1000	970mm	1 pcs	1700 ¥
FLT-RL-1500	1470mm	1 pcs	2000 ¥
FLT-RL-2900	1970mm	1 pcs	2500 ¥

In case of FLT-RL-500/1000 you shall use 5 mounting clip.
In case of FLT-RL-1500/2000 you shall use 10 mounting clip.

Jumper cable FMP-DG



FMP-DG	3000 mm	1 pcs	3500 ¥
--------	---------	-------	--------

Power supply out cable FMP-1



FMP-1	500mm	1 pcs	2500 ¥
-------	-------	-------	--------

Power supply in lead cable FMP-2



FMP-2	500mm	1 pcs	2500 ¥
-------	-------	-------	--------

Power supply unit (OSRAM OT)



OT30/100-200-24-T	30W	1 pcs	Open price
OT60/100-200-24-T	60W	1 pcs	Open price
OT90/100-200-24-T	90W	1 pcs	Open price
OT150/100-200-24-T	150W	1 pcs	Open price

Input AC90~240V, output DC24V.
Comply with CE, UL, PSE standards. IP 66 water proof rating.

DC 24V dimmer FMC-24S/R



FMC-24S/R	1 pcs	34500 ¥
-----------	-------	---------

Available in 3 colors:



DC 24V simple dimmer FSD-24

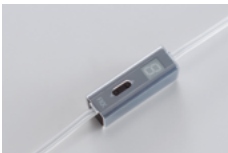

FSD-24	1 pcs	9900 ¥
--------	-------	--------

Installation / Power supply connection

Mounting rail installation

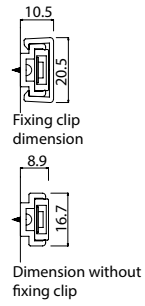
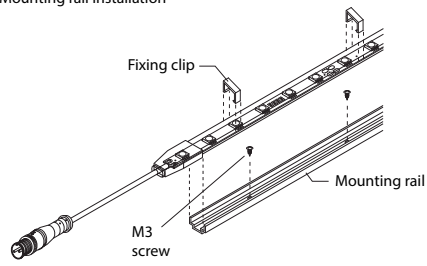

Mounting bracket installation

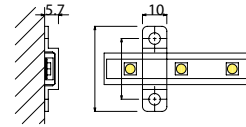
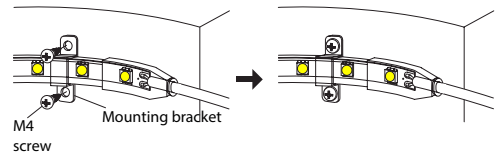

* Please always use washers when fixing the brackets.

Installation / Power supply connection

