

FLT-3PGA

LED Flexible Module



- Built-in phosphorescence function, produce bright light even when the power is off
- Visible in the dark even after 10 hours
- Up to 6.5 m standard length
- IP 65~67 waterproof

FLT-3PGA - 1016 - N - K

1	2	3	4
1 Fixture name :		FLT-3PGA= LED Flexible Module FLare Line PLC Outdoor	
Length :		70mm~6494mm	
3 LED color :		L25 = Light bulb (2500K) L27 = Light bulb (2700K) L30 = Light bulb (3000K) WW = Warm white (3500K) W = White (4000K) N = Neutral white (5000K) D = Daylight (6500K)	
4 Connector:		None = standard/K = one end connector	
Environment of use :		outdoor accent / architectural lighting /IP65~67	
Maximum length in series :		6.5m (6494mm) (longer possible upon request)	
Driver :		DC 24V	
CRI:		> 80 Ra	

Color temperature CCT

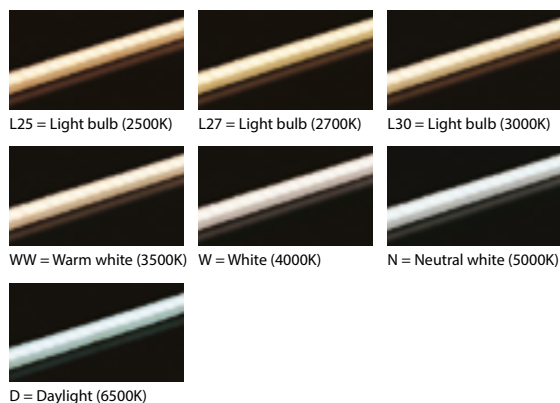

Photometric data

Measured fixture: FLT-3PGA-1016-N

Light Intensity distribution

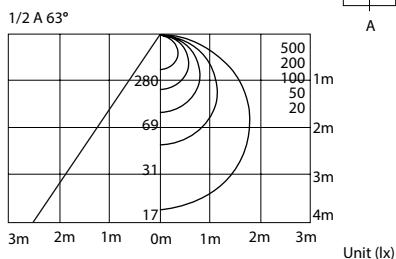

Candlepower Distribution

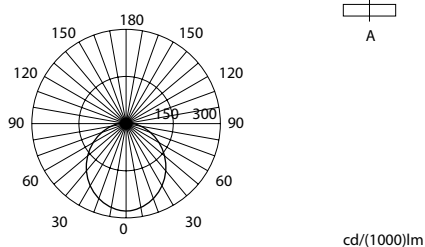

Dimensions

Unit (mm)

External dimension

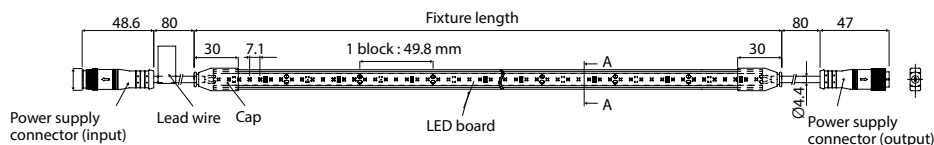

Cross sectional view A-A

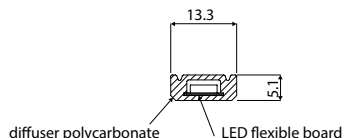

Order made sizes

Reference	Length (mm)	Weight (kg)	No. of LED	Watts (W)	Amps (A)	Luminous flux (lm)
FLT-3PGA-70	70	0.024	7	0.5	0.02	45
FLT-3PGA-120	120	0.049	14	1.0	0.04	90
FLT-3PGA-169	169	0.073	21	1.4	0.06	135
FLT-3PGA-219	219	0.098	28	1.9	0.08	180
FLT-3PGA-269	269	0.122	35	2.4	0.10	225
FLT-3PGA-319	319	0.146	42	2.9	0.12	270
FLT-3PGA-369	369	0.171	49	3.4	0.14	315
FLT-3PGA-418	418	0.195	56	3.8	0.16	360
FLT-3PGA-468	468	0.220	63	4.3	0.18	405
FLT-3PGA-518	518	0.244	70	4.8	0.20	450
FLT-3PGA-568	568	0.268	77	5.3	0.22	495
FLT-3PGA-618	618	0.293	84	5.8	0.24	540
FLT-3PGA-667	667	0.317	91	6.2	0.26	585
FLT-3PGA-717	717	0.342	98	6.7	0.28	630
FLT-3PGA-767	767	0.366	105	7.2	0.30	675
FLT-3PGA-817	817	0.390	112	7.7	0.32	720
FLT-3PGA-867	867	0.415	119	8.2	0.34	765
FLT-3PGA-916	916	0.439	126	8.6	0.36	810
FLT-3PGA-966	966	0.464	133	9.1	0.38	855
FLT-3PGA-1016	1016	0.488	140	9.6	0.40	900
FLT-3PGA-1066	1066	0.512	147	10.1	0.42	945
FLT-3PGA-1116	1116	0.537	154	10.6	0.44	990
FLT-3PGA-1165	1165	0.561	161	11.0	0.46	1035
FLT-3PGA-1215	1215	0.586	168	11.5	0.48	1080
FLT-3PGA-1265	1265	0.610	175	12.0	0.50	1125
FLT-3PGA-1315	1315	0.634	182	12.5	0.52	1170
FLT-3PGA-1365	1365	0.659	189	13.0	0.54	1215
FLT-3PGA-1414	1414	0.683	196	13.4	0.56	1260
FLT-3PGA-1464	1464	0.708	203	13.9	0.58	1305
FLT-3PGA-1514	1514	0.732	210	14.4	0.60	1350
FLT-3PGA-1564	1564	0.756	217	14.9	0.62	1395
FLT-3PGA-1614	1614	0.781	224	15.4	0.64	1440
FLT-3PGA-1663	1663	0.805	231	15.8	0.66	1485
FLT-3PGA-1713	1713	0.830	238	16.3	0.68	1530
FLT-3PGA-1763	1763	0.854	245	16.8	0.70	1575
FLT-3PGA-1813	1813	0.878	252	17.3	0.72	1620
FLT-3PGA-1863	1863	0.903	259	17.8	0.74	1665
FLT-3PGA-1912	1912	0.927	266	18.2	0.76	1710
FLT-3PGA-1962	1962	0.952	273	18.7	0.78	1755
FLT-3PGA-2012	2012	0.976	280	19.2	0.80	1800
FLT-3PGA-2062	2062	1.000	287	19.7	0.82	1845
FLT-3PGA-2112	2112	1.025	294	20.2	0.84	1890
FLT-3PGA-2161	2161	1.049	301	20.6	0.86	1935
FLT-3PGA-2211	2211	1.074	308	21.1	0.88	1980
FLT-3PGA-2261	2261	1.098	315	21.6	0.90	2025
FLT-3PGA-2311	2311	1.122	322	22.1	0.92	2070
FLT-3PGA-2361	2361	1.147	329	22.6	0.94	2115
FLT-3PGA-2410	2410	1.171	336	23.0	0.96	2160
FLT-3PGA-2460	2460	1.196	343	23.5	0.98	2205
FLT-3PGA-2510	2510	1.220	350	24.0	1.00	2250
FLT-3PGA-2560	2560	1.244	357	24.5	1.02	2295
FLT-3PGA-2610	2610	1.269	364	25.0	1.04	2340
FLT-3PGA-2659	2659	1.293	371	25.4	1.06	2385
FLT-3PGA-2709	2709	1.318	378	25.9	1.08	2430
FLT-3PGA-2759	2759	1.342	385	26.4	1.10	2475
FLT-3PGA-2809	2809	1.366	392	26.9	1.12	2520
FLT-3PGA-2859	2859	1.391	399	27.4	1.14	2565
FLT-3PGA-2908	2908	1.415	406	27.8	1.16	2610
FLT-3PGA-2958	2958	1.440	413	28.3	1.18	2655
FLT-3PGA-3008	3008	1.464	420	28.8	1.20	2700
FLT-3PGA-3058	3058	1.488	427	29.3	1.22	2745
FLT-3PGA-3108	3108	1.513	434	29.8	1.24	2790
FLT-3PGA-3157	3157	1.537	441	30.2	1.26	2835
FLT-3PGA-3207	3207	1.562	448	30.7	1.28	2880
FLT-3PGA-3257	3257	1.586	455	31.2	1.30	2925

Reference	Length (mm)	Weight (kg)	No. of LED	Watts (W)	Amps (A)	Luminous flux (lm)
FLT-3PGA-3307	3307	1.610	462	31.7	1.32	2970
FLT-3PGA-3357	3357	1.635	469	32.2	1.34	3015
FLT-3PGA-3406	3406	1.659	476	32.6	1.36	3060
FLT-3PGA-3456	3456	1.684	483	33.1	1.38	3105
FLT-3PGA-3506	3506	1.708	490	33.6	1.40	3150
FLT-3PGA-3556	3556	1.732	497	34.1	1.42	3195
FLT-3PGA-3606	3606	1.757	504	34.6	1.44	3240
FLT-3PGA-3655	3655	1.781	511	35.0	1.46	3285
FLT-3PGA-3705	3705	1.806	518	35.5	1.48	3330
FLT-3PGA-3755	3755	1.830	525	36.0	1.50	3375
FLT-3PGA-3805	3805	1.854	532	36.5	1.52	3420
FLT-3PGA-3855	3855	1.879	539	37.0	1.54	3465
FLT-3PGA-3904	3904	1.903	546	37.4	1.56	3510
FLT-3PGA-3954	3954	1.928	553	37.9	1.58	3555
FLT-3PGA-4004	4004	1.952	560	38.4	1.60	3600
FLT-3PGA-4054	4054	1.976	567	38.9	1.62	3645
FLT-3PGA-4104	4104	2.001	574	39.4	1.64	3690
FLT-3PGA-4153	4153	2.025	581	39.8	1.66	3735
FLT-3PGA-4203	4203	2.050	588	40.3	1.68	3780
FLT-3PGA-4253	4253	2.074	595	40.8	1.70	3825
FLT-3PGA-4303	4303	2.098	602	41.3	1.72	3870
FLT-3PGA-4353	4353	2.123	609	41.8	1.74	3915
FLT-3PGA-4402	4402	2.147	616	42.2	1.76	3960
FLT-3PGA-4452	4452	2.172	623	42.7	1.78	4005
FLT-3PGA-4502	4502	2.196	630	43.2	1.80	4050
FLT-3PGA-4552	4552	2.220	637	43.7	1.82	4095
FLT-3PGA-4602	4602	2.245	644	44.2	1.84	4140
FLT-3PGA-4651	4651	2.269	651	44.6	1.86	4185
FLT-3PGA-4701	4701	2.294	658	45.1	1.88	4230
FLT-3PGA-4751	4751	2.318	665	45.6	1.90	4275
FLT-3PGA-4801	4801	2.342	672	46.1	1.92	4320
FLT-3PGA-4851	4851	2.367	679	46.6	1.94	4365
FLT-3PGA-4900	4900	2.391	686	47.0	1.96	4410
FLT-3PGA-4950	4950	2.416	693	47.5	1.98	4455
FLT-3PGA-5000	5000	2.440	700	48.0	2.00	4500
FLT-3PGA-5050	5050	2.464	707	48.5	2.02	4545
FLT-3PGA-5100	5100	2.489	714	49.0	2.04	4590
FLT-3PGA-5149	5149	2.513	721	49.4	2.06	4635
FLT-3PGA-5199	5199	2.538	728	49.9	2.08	4680
FLT-3PGA-5249	5249	2.562	735	50.4	2.10	4725
FLT-3PGA-5299	5299	2.586	742	50.9	2.12	4770
FLT-3PGA-5349	5349	2.611	749	51.4	2.14	4815
FLT-3PGA-5398	5398	2.635	756	51.8	2.16	4860
FLT-3PGA-5448	5448	2.660	763	52.3	2.18	4905
FLT-3PGA-5498	5498	2.684	770	52.8	2.20	4950
FLT-3PGA-5548	5548	2.708	777	53.3	2.22	4995
FLT-3PGA-5598	5598	2.733	784	53.8	2.24	5040
FLT-3PGA-5647	5647	2.757	791	54.2	2.26	5085
FLT-3PGA-5697	5697	2.782	798	54.7	2.28	5130
FLT-3PGA-5747	5747	2.806	805	55.2	2.30	5175
FLT-3PGA-5797	5797	2.830	812	55.7	2.32	5220
FLT-3PGA-5847	5847	2.855	819	56.2	2.34	5265
FLT-3PGA-5896	5896	2.879	826	56.6	2.36	5310
FLT-3PGA-5946	5946	2.904	833	57.1	2.38	5355
FLT-3PGA-5996	5996	2.928	840	57.6	2.40	5400
FLT-3PGA-6046	6046	2.952	847	58.1	2.42	5445
FLT-3PGA-6096	6096	2.977	854	58.6	2.44	5490
FLT-3PGA-6145	6145	3.001	861	59.0	2.46	5535
FLT-3PGA-6195	6195	3.026	868	59.5	2.48	5580
FLT-3PGA-6245	6245	3.050	875	60.0	2.50	5625
FLT-3PGA-6295	6295	3.074	882	60.5	2.52	5670
FLT-3PGA-6345	6345	3.099	889	61.0	2.54	5715
FLT-3PGA-6394	6394	3.123	896	61.4	2.56	5760
FLT-3PGA-6444	6444	3.148	903	61.9	2.58	5805
FLT-3PGA-6494	6494	3.172	910	62.4	2.60	5850

* Maximum standard length 6.5m. For longer specification, please contact us.

Option parts

Mounting bracket FLT-CR

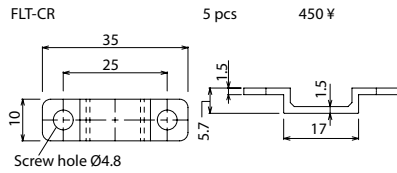

Mounting clip FLT-RLC

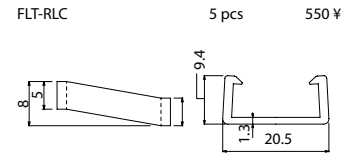

Mounting rail FLT-RL



FLT-RL-500	470mm	1 pcs	1500 ¥
FLT-RL-1000	970mm	1 pcs	1700 ¥
FLT-RL-1500	1470mm	1 pcs	2000 ¥
FLT-RL-2900	1970mm	1 pcs	2500 ¥

In case of FLT-RL-500/1000 you shall use 5 mounting clip.
In case of FLT-RL-1500/2000 you shall use 10 mounting clip.

Jumper cable FMP-DG



FMP-DG	3000 mm	1 pcs	3500 ¥
--------	---------	-------	--------

Power supply out cable FMP-1



FMP-1	500mm	1 pcs	2500 ¥
-------	-------	-------	--------

Power supply in lead cable FMP-2



FMP-2	500mm	1 pcs	2500 ¥
-------	-------	-------	--------

Power supply unit (OSRAM OT)



OT30/100-200-24-T	30W	1 pcs	Open price
OT60/100-200-24-T	60W	1 pcs	Open price
OT90/100-200-24-T	90W	1 pcs	Open price
OT150/100-200-24-T	150W	1 pcs	Open price

Input AC90~240V, output DC24V.
Comply with CE, UL, PSE standards. IP 66 water proof rating.

DC 24V dimmer FMC-24S/R



FMC-24S/R	1 pcs	34500 ¥
-----------	-------	---------

Available in 3 colors:



DC 24V simple dimmer FSD-24



FSD-24	1 pcs	9900 ¥
--------	-------	--------

Installation / Power supply connection

Mounting rail installation

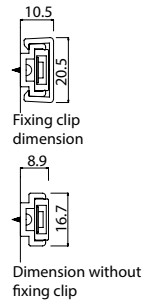
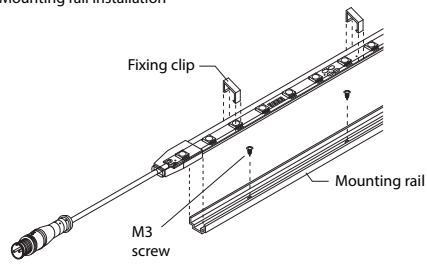

Mounting bracket installation

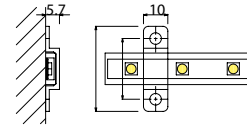
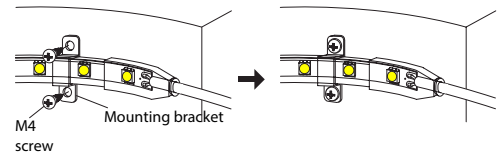

* Please always use washers when fixing the brackets.

Installation / Power supply connection

